

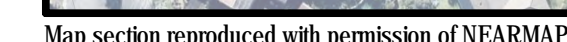

CHERRYBROOK SHOPPING CENTRE
41-47 SHEPHERDS DRIVE,
CHERRYBROOK
DEVELOPMENT APPLICATION

COVER SHEET

LOCALITY PLAN & DRAWING LIST



INDICATIVE AREA OF WORKS

CIVIL DRAWINGS	
NUMBER	TITLE
80816134-CI-100	COVER SHEET, LOCALITY PLAN & DRAWING LIST
80816134-CI-110	CONCEPT STORMWATER PLAN - GROUND LEVEL
80816134-CI-115	CONCEPT STORMWATER PLAN - LOWER GROUND LEVEL
80816134-CI-120	EROSION & SEDIMENT CONTROL PLAN
80816134-CI-125	EROSION & SEDIMENT CONTROL DETAILS

¥ Cardno Limited All Rights Reserved.
This document is produced by Cardno Limited solely
for the benefit of and use by the client in accordance
with the terms of the agreement between the client and
Cardno Limited and shall not assume any responsibility or liability
whatsoever to any third party arising out of any use or
reliance by third party on the content of this document.

Drawn	LDB	Date	07/09/16	Status					
Checked	SGB	Date	07/09/16	DEVELOPMENT APPROVAL NOT TO BE USED FOR CONSTRUCTION PURPOSES					
Designed	SN	Date	07/09/16						
Verified	SGB	Date	07/09/16		Scale	1:2000	Size	A1	
Approved				Drawing Number	80816134-CI-100			Revision	1
PW		Date	07/09/16						

1. WATER QUALITY DEVICE TO TARGET GROSS POLLUTANTS AND OIL/GRIT
2. PEAK FLOWS ASSESSED FOR CRITICAL 100YR DURATION IN 8F5BG" 7F4H758I F5HCB 9H49F" A-BI H9CF 8S MINUTE EVENT.
3. DESIGN RAINFALL, I = 232mm/hr FOR 5 MINUTE EVENT AND I = 132mm/hr FOR 20 MINUTE EVENT.
4. EXISTING IMPERVIOUS AREA DRAINING TO COUNCIL ROAD B9H KCF? 1& *- \U'
5. EXISTING CONDITION 100YR FLOW = 1,278L/s
6. PROPOSED IMPERVIOUS AREA DRAINING TO COUNCIL ROAD NETWORK = 2.941ha.
7. PROPOSED CONDITION 100YR FLOW = 1,333L/s
8. NET INCREASE IN IMPERVIOUS AREA IS APPROXIMATELY +700sqm (+2.5%)
9. NET INCREASE IN FLOW IS APPROXIMATELY +50L/s DURING 100YR STORM EVENT (+4.3%).
10. NET INCREASE IN IMPERVIOUS AREAS AND PEAK FLOWS ARE 7CB889F98 BG, @, 668I F-B; %SM 9J9BH' BC CG8 PROPOSED.
11. WATER QUALITY TREATMENT DEVICES AS SHOWN TREAT STORMWATER RUNOFF FROM THE PROPOSED 89J9CDA9BH' 7CI B7-@CK 5H9F EI 54M4BF; 9HG5F9 MET. REFER CARDNO STORMWATER QUALITY REPORT FOR ADDITIONAL INFORMATION.
12. OVERALL POLLUTANT LOADING LEAVING THE SITE FOLLOWING DEVELOPMENT (WITH CONSIDERATION TO RETAINED AND DEVELOPED SITE AREAS) IS LESS THAN THOSE UNDER EXISTING SITE CONDITIONS. REFER CARDNO STORMWATER QUALITY REPORT FOR ADDITIONAL INFORMATION.

CONSTRUCT STUBS FOR
DOWNPIPE CONNECTION.
FINAL POSITION SUBJECT
TO HYDRAULIC DESIGN.
(TYP)

EXISTING PIPE CONNECTS TO
LOWER GROUND LEVEL DRAINAGE.
REFER DWG CI-115.

STORMWATER PITS OR FLUGO
OUTLETS IN GROUND LEVEL
CARPARK DECK. DISCHARGE TO
LOWER GROUND LEVEL DRAINAGE.
(TYP)

CONNECT TO EXISTING PIT. CONFIRM
LOCATION AND DEPTH OF OPTUS SERVICE.
CONNECTS TO LOWER GROUND LEVEL
DRAINAGE. REFER DWG CI-115.

© Cardno Limited All Rights Reserved.
This document is produced by Cardno Limited solely for the
benefit of and use by the client in accordance with the
Mag~~g~~ZHYMUB"7UNc @pYXXYgbHLbXgU b
assume any responsibility or liability whatsoever to any third
party arising out of any use or reliance by third party on the
content of this document.





Drawn	Date
LDB	07/09/16
Checked	Date
SGB	07/09/16
Designed	Date
SN	07/09/16
Verified	Date
SGB	07/09/16
Approved	Date
PW	07/09/16

Client	MIRVAC
Project	CHERRYBROOK SHOPPING CENTRE 41-47 SHEPHERDS DRIVE, CHERRYBROOK DEVELOPMENT APPLICATION
Title	- CONCEPT STORMWATER PLAN GROUND LEVEL

Status DEVELOPMENT APPROVAL NOT TO BE USED FOR CONSTRUCTION PURPOSES			
Datum	Register	Scale	Size
-	-	1:500	A1
Drawing Number			Revision
80816134-CI-110			1

LEGEND

-  PROPOSED STORMWATER
 EXISTING STORMWATER TO BE RETAINED
 EXISTING STORMWATER TO BE REMOVED

PLAN
SCALE 1:500



I	07/09/16	D.A. ISSUE			SN	SGB	PW
Rev.	Date	Description			Des.	Venf.	Appd.

1. WATER QUALITY DEVICE TO TARGET GROSS POLLUTANTS AND OIL/GRIT
2. PEAK FLOWS ASSESSED FOR CRITICAL 100YR DURATION IN 8F5BG" 7F4H758I F5HCB 9H49F" A-BI H9CF 8S MINUTE EVENT.
3. DESIGN RAINFALL, I = 232mm/hr FOR 5 MINUTE EVENT AND I = 132mm/hr FOR 20 MINUTE EVENT.
4. EXISTING IMPERVIOUS AREA DRAINING TO COUNCIL ROAD B9H KCF? 1& *- \U'
5. EXISTING CONDITION 100YR FLOW = 1,278L/s
6. PROPOSED IMPERVIOUS AREA DRAINING TO COUNCIL ROAD NETWORK = 2.941ha.
7. PROPOSED CONDITION 100YR FLOW = 1,333L/s
8. NET INCREASE IN IMPERVIOUS AREA IS APPROXIMATELY +700sqm (+2.5%)
9. NET INCREASE IN FLOW IS APPROXIMATELY +50L/s DURING 100YR STORM EVENT (+4.3%).
10. NET INCREASE IN IMPERVIOUS AREAS AND PEAK FLOWS ARE 7CB889F98 BG, @, 668I F-B; %SM 9J9BH' BC CG8 PROPOSED.
11. WATER QUALITY TREATMENT DEVICES AS SHOWN TREAT STORMWATER RUNOFF FROM THE PROPOSED 89J9CDA9BH' 7CI B7-@CK 5H9F EI 54M4BF; 9HG5F9 MET. REFER CARDNO STORMWATER QUALITY REPORT FOR ADDITIONAL INFORMATION.
12. OVERALL POLLUTANT LOADING LEAVING THE SITE FOLLOWING DEVELOPMENT (WITH CONSIDERATION TO RETAINED AND DEVELOPED SITE AREAS) IS LESS THAN THOSE UNDER EXISTING SITE CONDITIONS. REFER CARDNO STORMWATER QUALITY REPORT FOR ADDITIONAL INFORMATION.



0 10 20 30 40 50m

SCALE 1:500 @A1

¥ Cardno Limited All Rights Reserved.
This document is produced by Cardno Limited solely for the benefit of and use by the client in accordance with the ~~MagcZHYNYJYr7UXC@BXXEgbcLUXGUbcl~~ assume any responsibility or liability whatsoever to any third party arising out of any use or reliance by third party on the content of this document.





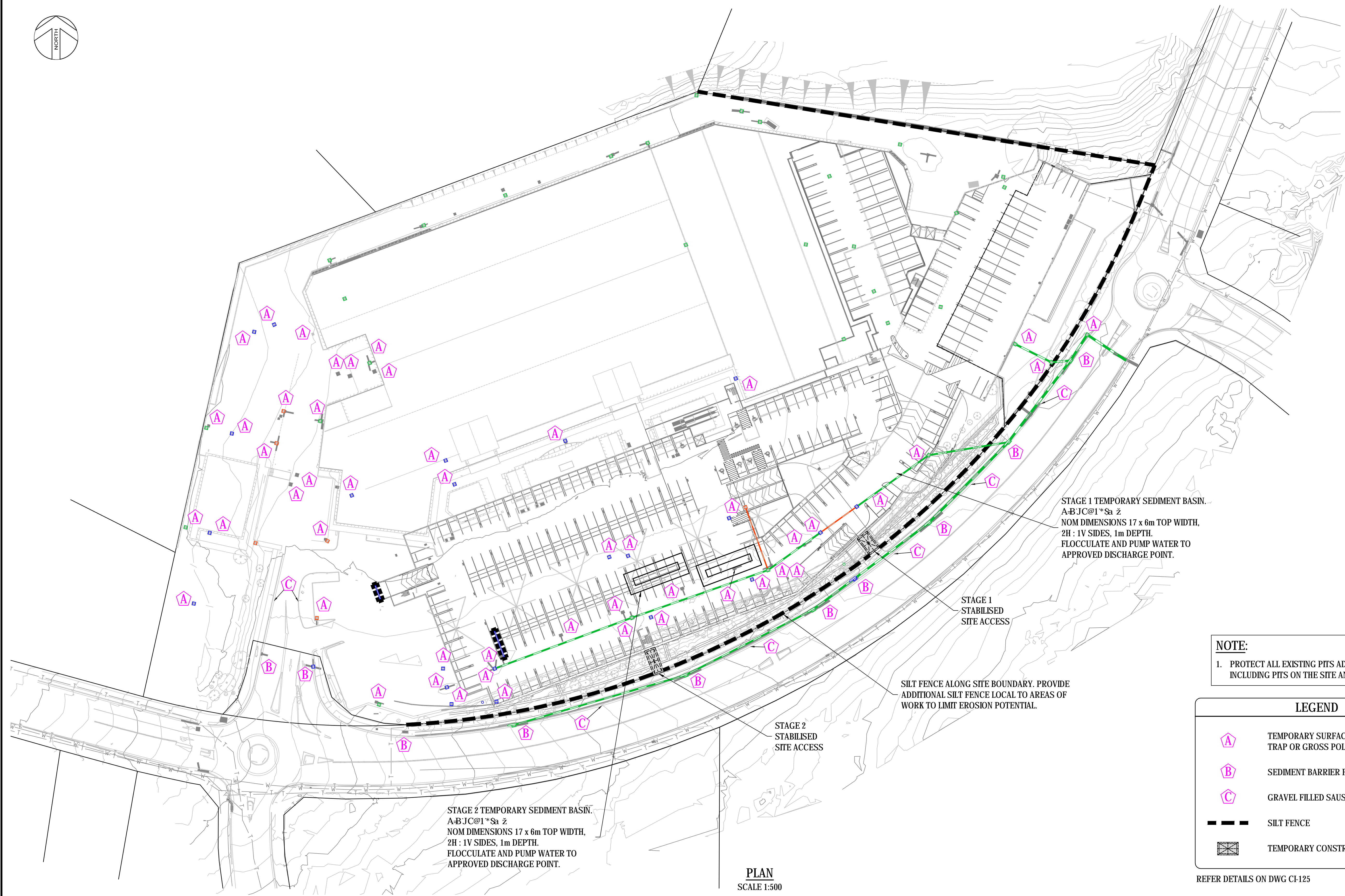
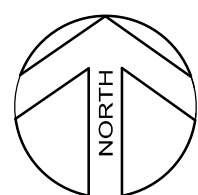

Client	MIRVAC
Project	CHERRYBROOK SHOPPING CENTRE 41-47 SHEPHERDS DRIVE, CHERRYBROOK DEVELOPMENT APPLICATION
Title	CONCEPT STORMWATER PLAN LOWER GROUND LEVEL

Status			
DEVELOPMENT APPROVAL			
NOT TO BE USED FOR CONSTRUCTION PURPOSES			
Date	Register	Scale	Size
-	-	1:500	A1
Drawing Number			Revision
80816134-CI-115			1



NOTE:

1. PROTECT ALL EXISTING PITS ADJACENT TO WORKS INCLUDING PITS ON THE SITE AND IN THE STREET.

LEGEND	
	TEMPORARY SURFACE INLET SEDIMENT TRAP OR GROSS POLLUTANT TRAP
	SEDIMENT BARRIER FOR KERB INLET PITS
	GRAVEL FILLED SAUSAGE
	SILT FENCE
	TEMPORARY CONSTRUCTION VEHICLE EXIT

REFER DETAILS ON DWG CI-125

1	07/09/16	D.A. ISSUE	SN	SGB	PW
Rev.	Date	Description	Des.	Verif.	Appd.

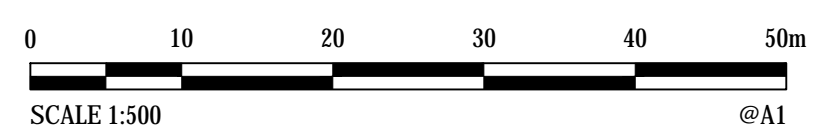

¥ Cardno Limited All Rights Reserved.
This document is produced by Cardno Limited solely for the benefit of and use by the client in accordance with the M@gcZHYMYJY7UX6c@aJXXcYgbcHUXgAUbch assume any responsibility or liability whatsoever to any third party arising out of any use or reliance by third party on the content of this document.



Drawn LDB	Date 07/09/16	Client MIRVAC				
Checked SGB	Date 07/09/16	Project CHERRYBROOK SHOPPING CENTRE 41-47 SHEPHERDS DRIVE, CHERRYBROOK DEVELOPMENT APPLICATION	Status DEVELOPMENT APPROVAL NOT TO BE USED FOR CONSTRUCTION PURPOSES			
Designed SN	Date 07/09/16		Datum -	Register -	Scale 1:500	Size A1
Verified SGB	Date 07/09/16	Title EROSION & SEDIMENT CONTROL PLAN	Drawing Number 80816134-CI-120			Revision 1
Approved	Date					
PW	07/09/16					

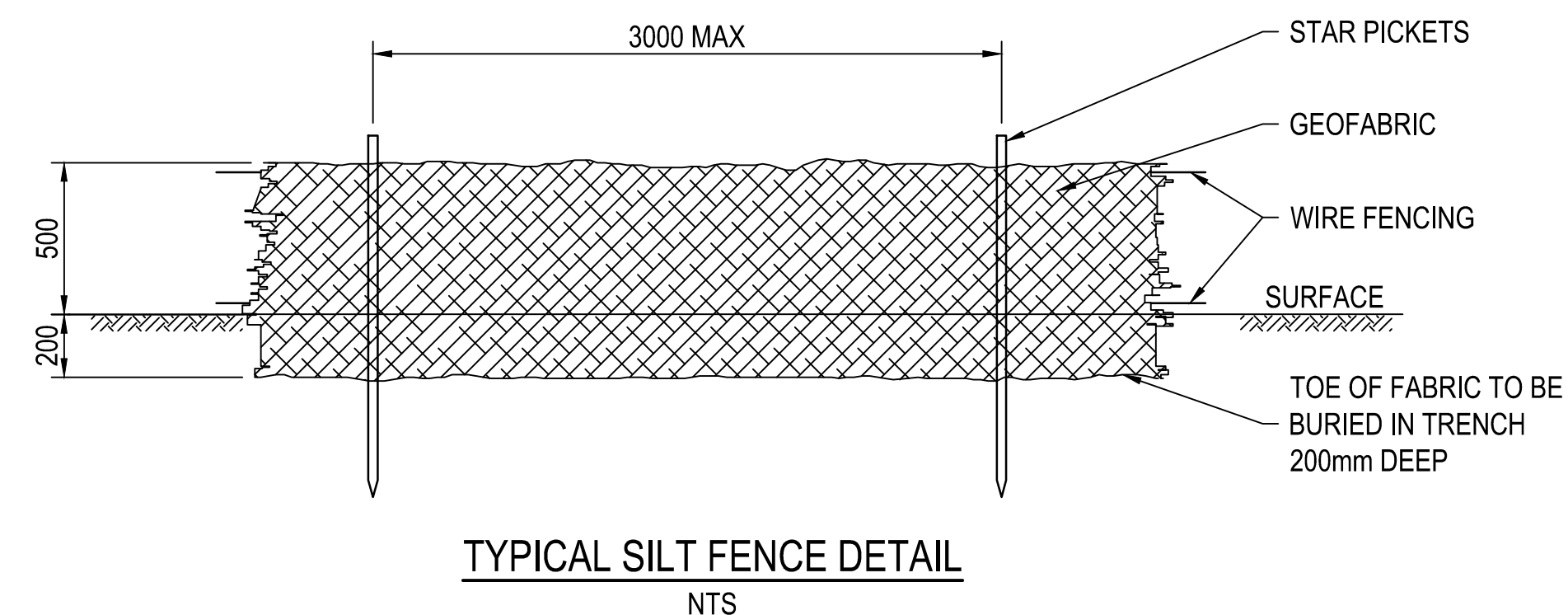

NOTE:

1. FLOCCULATE BASIN WATER AND PUMP TO APPROVED DISCHARGE POINT.

[illegible]

¥ Cardno Limited All Rights Reserved.
This document is produced by Cardno Limited solely for the benefit of and use by the client in accordance with the



Drawn LDB	Date 07/09/16	Client MIRVAC	<div><div>DEVELOPMENT APPROVAL</div><div>NOT TO BE USED FOR CONSTRUCTION PURPOSES</div></div>			
Checked SGB	Date 07/09/16	Project CHERRYBROOK SHOPPING CENTRE 41-47 SHEPHERDS DRIVE, CHERRYBROOK DEVELOPMENT APPLICATION				
Designed SN	Date 07/09/16	Title EROSION & SEDIMENT CONTROL DETAILS	Datum	Register	Scale	A1
Verified SGB	Date 07/09/16		Drawing Number			
Approved	Date		80816134-CI-125			
PW	07/09/16		Revision 1			